









LEGEND

-  Existing Tree
-  Main Pedestrian Access
-  Low vegetation buffer zone (upto 5m wide)
-  Revegetation buffer zone (upto 5m wide)
(to incorporate existing vegetation)
-  Camping & Caravan site area. Site layout to be reconfigured once approval for additional sites is obtained.
-  Proposed 0.4m high vehicle barriers
-  Extent of Community Land to be dedicated as Public Road to facilitate road widening - comprising all of Lot 3 DP 125441.
-  Possible coastal walkway to link with the Narooma Mill Bay Boardwalk.

NOTES

Camping Sites

It is proposed that the Approval for the camping ground be amended to accommodate up to 100 sites on the camping ground on the completion of the new amenities building. Minimise size for each site is 50m².

New Amenities Buildings & Service Area:

It is proposed that all services be located centrally.

The service area may include:

- * kitchen & cooking facilities
- * outdoor covered areas

Reconstruction of the intersection of Noble Parade and McMillan Crescent

The reconstruction of the intersection of Noble Parade and McMillan Crescent will require the removal of some existing vegetation. Replacement trees will be planted in more appropriate locations once the road reconstruction is complete.

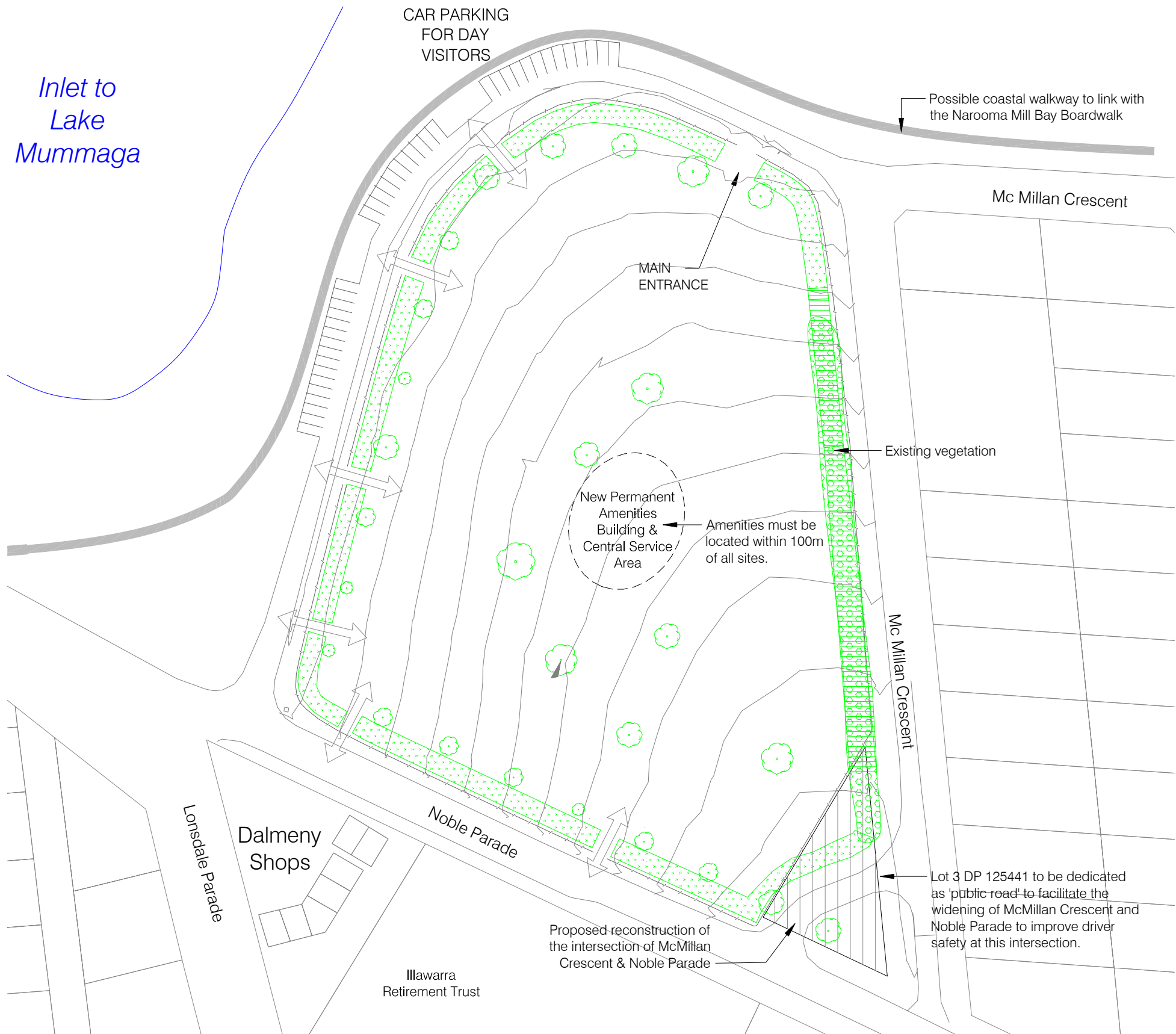

File Number	Datum	Designed For
	Surveyed	Design Speed
Cad Reference G:\14848\2003\2395\A.ppt\Plan of Management October 2003	Drawn DLP	Road Width
	Designed PC & DLP	Lane Width
Job Number	Checked	Pavement Depth

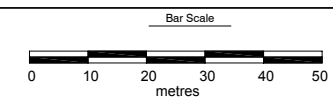

Approved On Behalf Of
EUROBODALLA SHIRE COUNCIL

Andrew Parkinson
Technical Services Manager
Date 25 November 2003

No.	Amendment Details	A	B	C	D	By	Appd	Date

Development Approval NOT Required



EUROBODALLA SHIRE COUNCIL
Dalmeny Camping Ground
Plan of Management
Site Concept Masterplan
November 2003

Project No.	2395
Sheet of	2
Set	A
Archived	

11.3 Site Concept Masterplan